

# JABRAYIL

FiFi 1, DP2, PSV



## GENERAL DATA

Type	Platform Supply Vessel
Design	UT755 LN
Shipyard	Aker Yard, Norway
Year built	2008
Class	DNVGL / RMRS
Flag	Azerbaijan
Port of registry/Call sign	Baku/4JRV
IMO	9395434

## DIMENSIONS

Length overall	73.6 m
Breadth	16.0 m
Maximum Draft	5.877 m
Summer Load Draft	5.877 m

## CARGO CARRYING CAPACITY

Gross Tonnage	2180 mt
Net Tonnage	1074 mt
Deadweight	3285 mt
Deck Dimension	51 x 13.4 m
Deck Area	600 m <sup>2</sup>
Point load	5 mt/m <sup>2</sup> (min)
Deck load	1600 mt

## TANK CAPACITIES

Fuel oil	1003 m <sup>3</sup> at 100%
Drill / Ballast Water	961 m <sup>3</sup> at 100%
Fresh Water	840 m <sup>3</sup> at 100%
Base Oil	211 m <sup>3</sup> at 100%
Brine	396 m <sup>3</sup> at 100%
Dry Bulk	320 m <sup>3</sup> at 100%
Oil based Mud	495 m <sup>3</sup> at 100%
Sewage	116 m <sup>3</sup> at 100%
Endurance	6 days

## SPEED

Maximum	12.5 kts
Economical	8.0 kts

## FUEL CONSUMPTION

Maximum	18.5 t / day
Economical	8.145 t / day
DP mode	8 t / day

## MACHINERY & PROPULSION

Main engines	MaK 6M25 2 x 1980 kW (2 x 2690 BHP)
Bow thrusters	2 x 590 kW (2 x 800 BHP)
Stern thrusters	2 x 590 kW (2 x 800 BHP)
Shaft alternators	2 x 1440 kWt (2 x 1958,4 BHP)
Diesel generator	2 x 250 kW (2x335 BHP)
Emergency generator	1 x 63,2 kWt (85,93 BHP)
Rudders	2 flap rudders

## FIREFIGHTING

FiFi	Class 1
Fixed system	CO <sub>2</sub> & Water system
FiFi Monitors	x 2
BA Scott (BAFOS)	x 6
EBBD	x 7

## LIFESAVING APPLIANCES

Life Raft	4 x 20
Lifejackets	29 pcs
Life-buoys	8 pcs + 4 pcs on DC
Immersion Suits	25 pcs

## DECK EQUIPMENT

Deck crane	1 x 3mt at 16m max.boom.
Tugger winches	2 x 10mt
Windlass/Capstans	2 x 8mt
Rescue boat	RR 4.2 Fassemer - 6 persons
Daughter craft	MP-1111 FRDC - 16 persons

## DP EQUIPMENT

DP System	Rolls-Royce Icon DP2
DP Class	DP2
DP References Systems	2 x DGPS Veripos Standard 1 x CyScan 1 x SceneScan

## COMMUNICATION EQUIPMENT

2 x Inmarsat-C Felcom 15
8 x Motorola DP1400 – Handheld VHF
2 x Motorola 360 - Handheld VHF
2 x Furuno 8800 D/8800S
1 x Furuno VHF radiotelephone RB 2721
2 x EPIRB SGE-406-II / TRON 40S MKII
2 x SART TRON SART 20

## NAVIGATION EQUIPMENT

1 x Furuno X-Band Radar, ARPA
1 x Furuno S-Band Radar, ARPA
1 x GPS Furuno GP-150
3 x Standard-22 Gyro Compass
1 x Sperry Navipilot 4000 Autopilot
1 x Furuno FA-150 AIS
1 x Furuno FE-700 Echosounder
1 x Furuno Doppler DS-80 Speed Log
2 x Wind Speed Director OMC139
1 x Northrop Grumman 2060 Magnetic Compass
1 x Furuno NX-700 Navtex
1 x Furuno X-Band Radar, ARPA
1 x Furuno S-Band Radar, ARPA
1 x GPS Furuno GP-150
3 x Standard-22 Gyro Compass
1 x Sperry Navipilot 4000 Autopilot
1 x Furuno FA-150 AIS
1 x Furuno FE-700 Echosounder
1 x Furuno Doppler DS-80 Speed Log

## ACCOMMODATION

Cabins capacity	10 cabins x 1 man 5 cabins x 2 man
Total POB	20 persons
Crew (minimum manning)	9 persons
Crew (normal operation)	16 persons
LSE	25 persons
Hospital	x 1
Client office	x 1

## UNIQUE VESSEL CHARACTERISTICS

Jabrayil is a modern (2008) Norwegian built PSV with DP2 capability and FiFi 1 system. The vessel has cargo deck capacity of 600 m2 and a maximum load of 1600 mt. In addition, the vessel can transport drill water, cement, brine and mud in dedicated tanks.

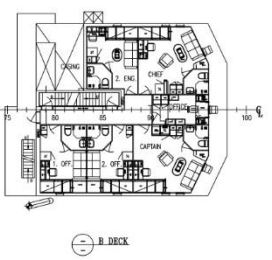
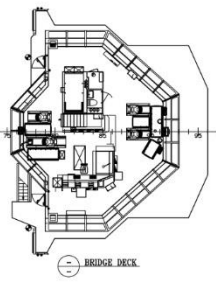
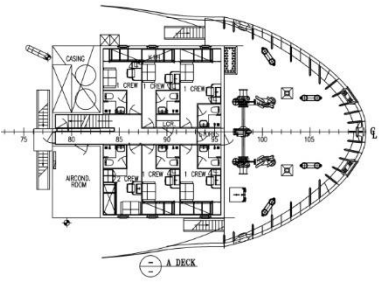
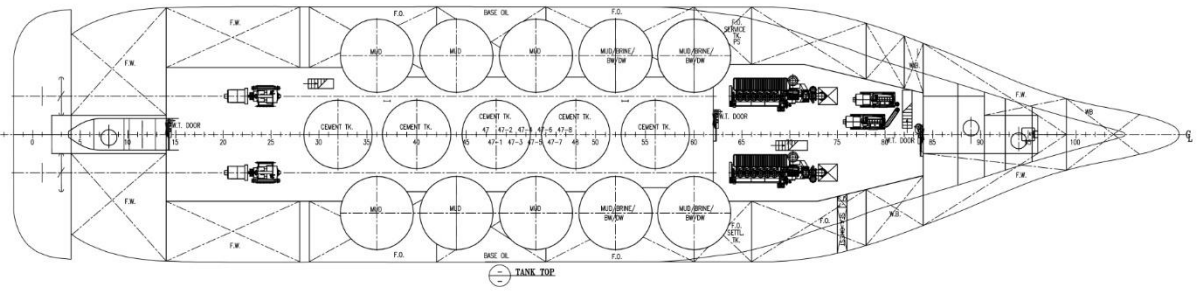
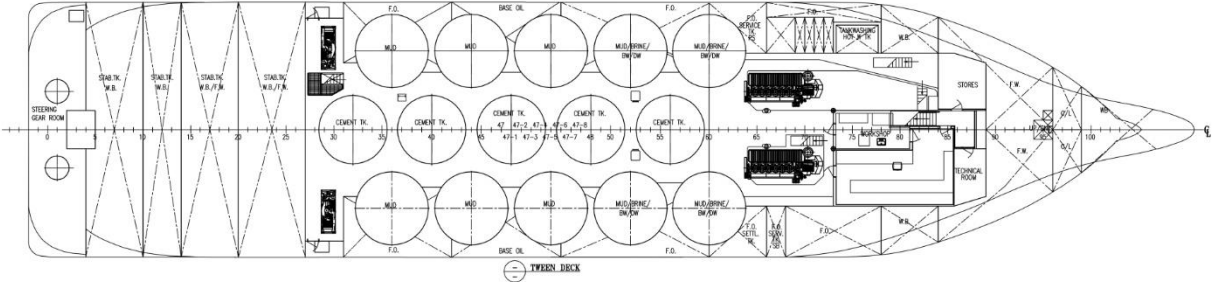
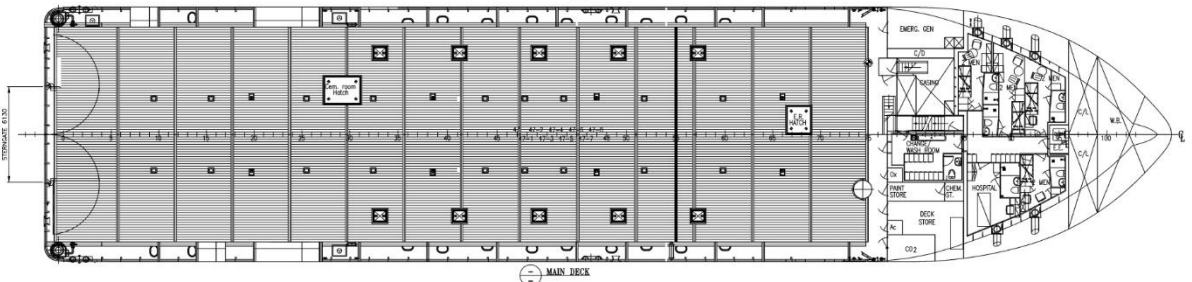
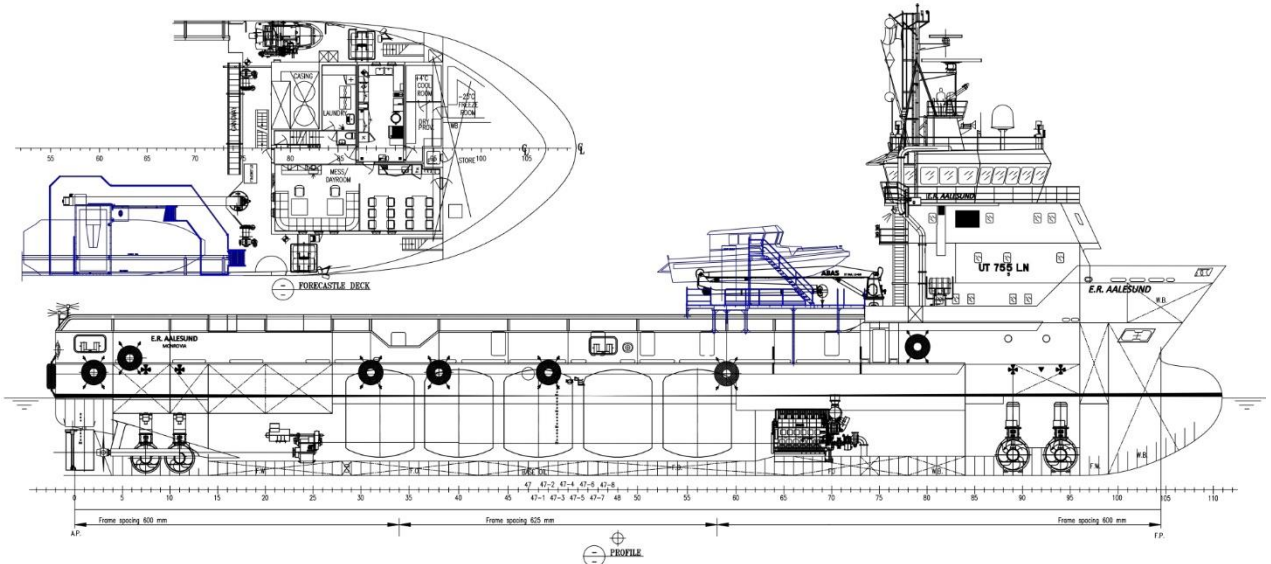

38 A, N.Aliyev street  
 AZ1025 Baku, Azerbaijan  
 T: +994 12 464 15 31 / 32  
 E: info@caspmarine.com  
 W: www.caspmarine.com

