

# ARAZ

Crew Boat 54 Pax  
50 tons deck cargo



## GENERAL DATA

Type	Crew boat
Year built / builder	2009, Topaz Shipbuilding, Fujairah, UAE
Class	(RMRS) KM ⚓ R2
Flag	Azerbaijan
Port of registry	Baku
Call sign	4JNX
IMO number	9573335

## DIMENSIONS

Length overall	35.0 m
Breadth	7.50 m
Summer Draft	1.9 m
Max Draft (protruding of propellers)	2.4 m
Freeboard at Summer Draft	1.516 m
Gross Tonnage	200 t
Net Tonnage	60 t
Deadweight max	93 t
Deck Working area	134.5 m <sup>2</sup>
Deck Strength	2 t/m <sup>2</sup>
Deck Cargo Capacity	50 t

## CAPACITIES

Fuel Oil	36,246 m <sup>3</sup>
Fresh Water	15,666 m <sup>3</sup>

## PROPULSION

Main Engines	3 x CAT C32 1081kw@2300rpm
Gearboxes	3 x Twin Disc MGX 6650 SC, 2.93:1
Propellers	3 x Teignbridge five blade propellers
Bow thruster	Thrustmaster 37 kW Hydraulic 16TT50L

## AUXILIARIES

Auxiliary set:	2 x CAT C4.4 107 KVA, 50 Hertz
Generators	415 VAC, 3 phase, 50Hz, 4 wires
Voltage	240 V AC, 1 phase, 50 Hz, 3 wires
Frequency	24 V DC circuit

## SPEED

Maximum	16.5 knots
Economical	11 knots

## FUEL CONSUMPTION PER DAY

Full Speed	9 m <sup>3</sup>
Economical	6.6 m <sup>3</sup>

## NAVIGATION EQUIPMENT

Radar	1 x Koden Radar
Echo Sounder	1 x F-3000W
Auto Pilot	1 x ALPHASEAPILOT MFC

**NAVIGATION EQUIPMENT**

Doppler Log	1 x NAVIKNOT 450 D
Navtex receiver	1 x Model NT-2000
GPS	1 x GPS plotter HGP 660

**COMMUNICATION EQUIPMENT**

MF/HF Transceiver	1 x Thrane&Thrane. Type: TU-5150
GMDSS	Inmarsat C, Type: TT-3000E MMSI: 423335100. Area 1, 2, 3
VHF	1 x Samyung, Type: STR 6000A. 1 x ICOM INC., Type: IC- M604

**LIFESAVING APPLIANCES**

Life Rafts	6 x 25 man
Lifejackets	66 (2 pcs for personnel on watch)
Immersion Suits	10 pcs
Rescue Boat	1 x 6 man

**COMMUNICATION EQUIPMENT**

MF Transceiver	1 x Furuno
Satcom	V-Sat
GMDSS	Inmarsat C, Area 1, 2, 3
VHF	2 x Furuno

**FIFI EQUIPMENT**

Fixed system	CO2
BA sets	x2

**ACCOMMODATION**

Cabins: Crew cabins	5 cabins: 2 single, 3 double cabins
Berth (Total)	8
Crew	8 persons
Passengers	54 persons

**MOORING EQUIPMENT**

Anchor	2 x Super High Holding Power 136.8 kg
Anchor chain	Grade 2 stud chain, breaking strength 151kN
Anchor winch	2 x HHAW 15-16, reel type, electro hydraulic

**CRANE**

1 x FASSI 1.075 T @ 10.05m

**VESSEL SPECIFIC CHARACTERISTICS**

Araz is a multipurpose vessel, able to transport 54 passengers plus crew and up to 50 tons of deck cargo at maximum speed of 16.5 knots. The knuckle / HIAB boom crane installed mid-ships on the port side allows materials to be quickly and easily transferred to or from the vessel. The deck area has been so arranged that 3 standard 20'' containers can be carried. Passengers are seated in a dedicated lounge in airline style seats and provided with an AV entertainment system so safety briefings can be observed prior to arriving at destination. Passenger transfer to installation can be achieved by Frog 3, basket transfer or direct access. Three fixed pitch propellers and additional bow tunnel thruster allowing excellent maneuverability and station keeping potential.

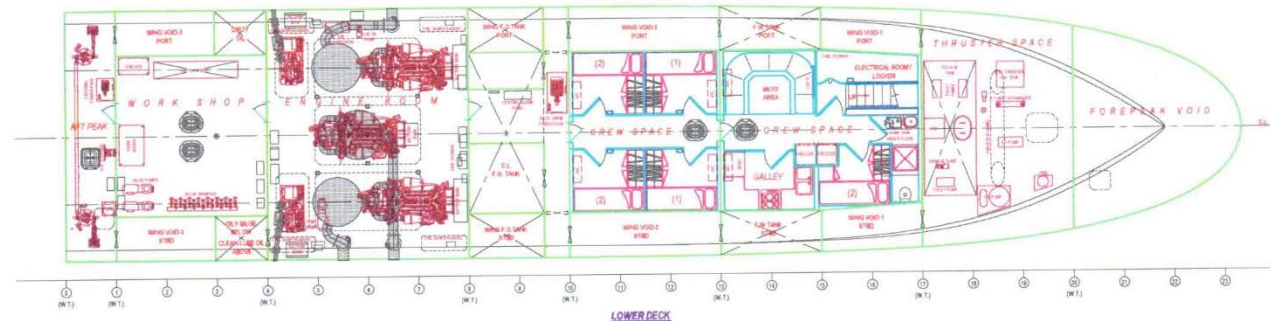
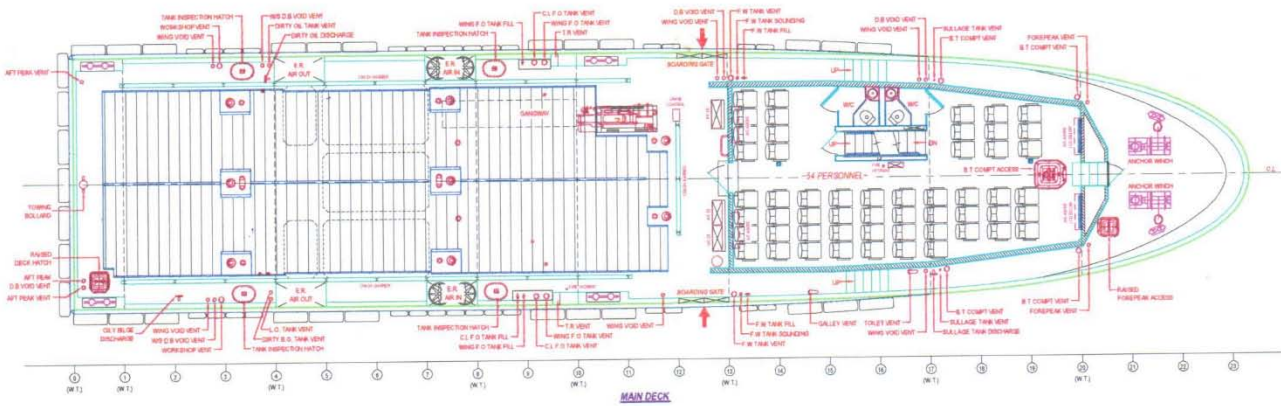
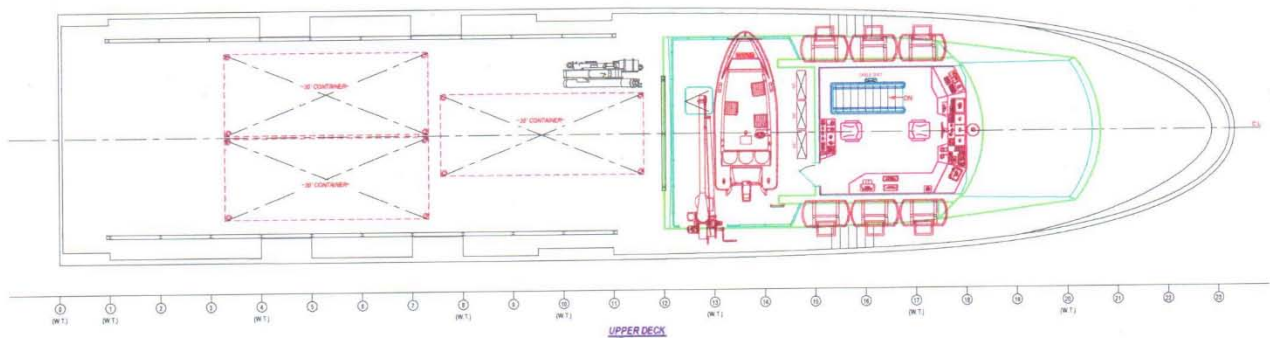
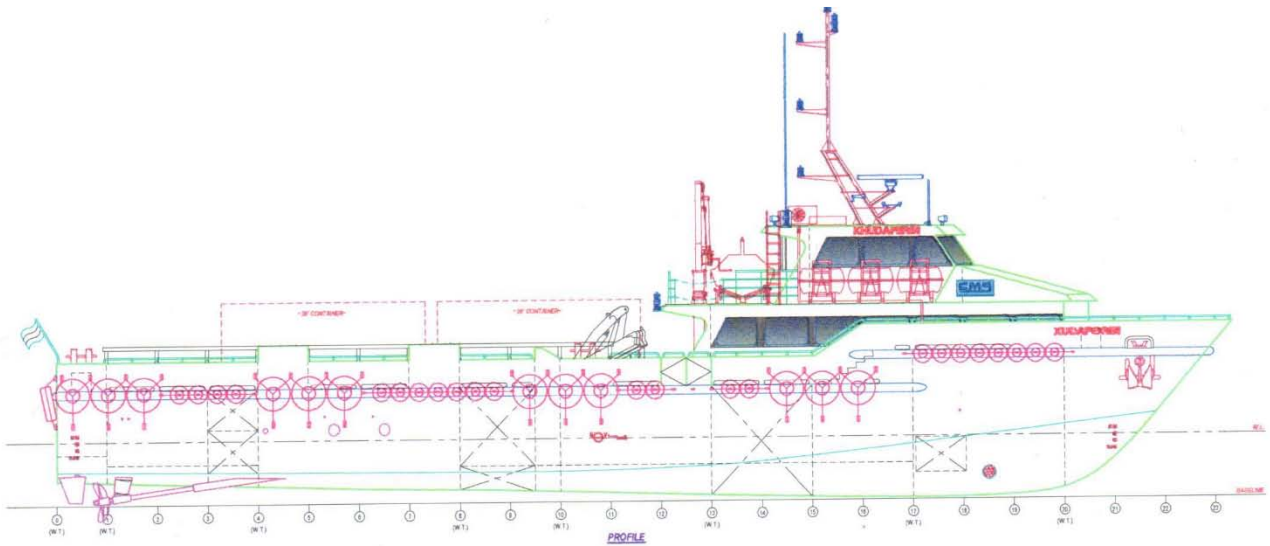

38 A, N.Aliyev street  
 AZ1025 Baku, Azerbaijan  
 T: +994 12 4641531 / 32  
 E: info@caspmarine.com  
 W: www.caspmarine.com

